

CONNECTOR: BENDIX PTIH-10-6P
MATE: BENDIX PTO6E-6S SUPPLIED UPON REQUEST

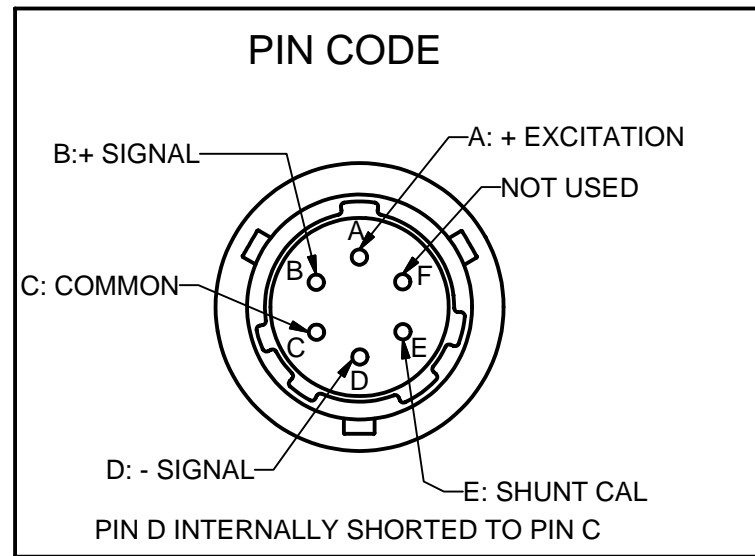
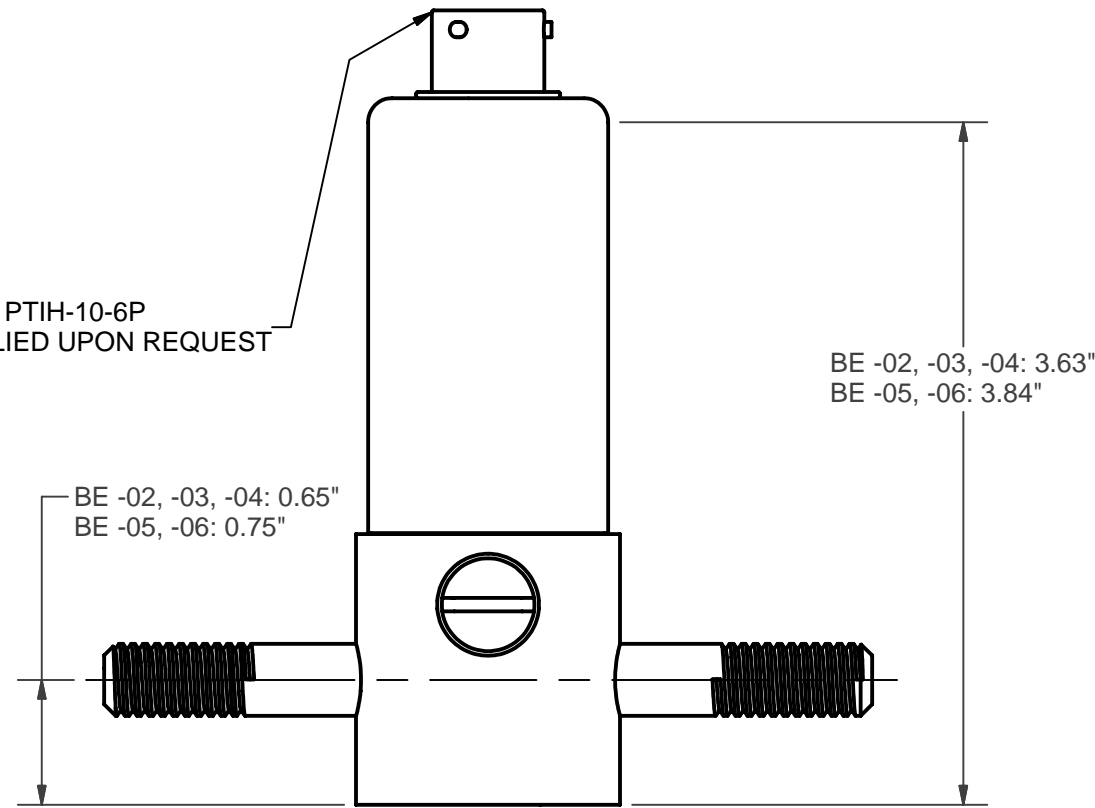
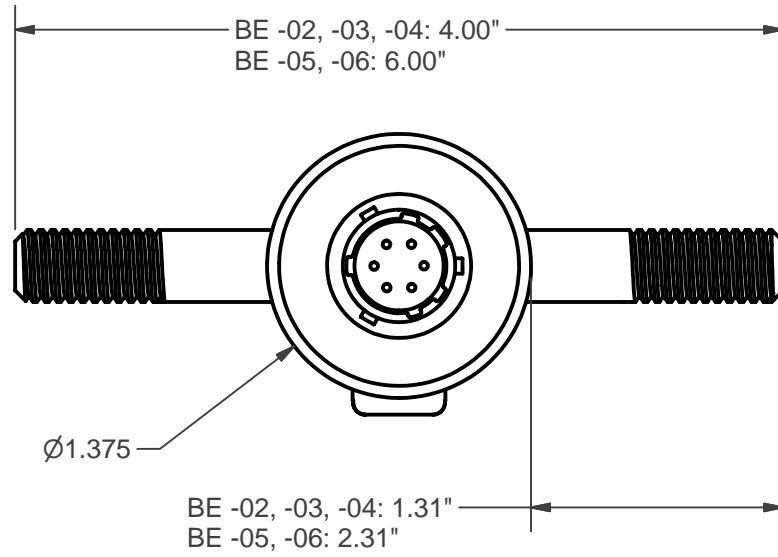

Pin	wire	desc
A	Red	+ Excitation
B	Green	+ Signal
C	Black	- Exc & - Sig
D		C&D are shorted Internally
E	White	Shunt Cal

Shorting White to Black simulates output on Label
DO NOT LEAVE WHITE AND BLACK SHORTED DURING NORMAL USE

SPECIFICATIONS

Storage Temp: -30F To +250F
Compensated Temp Range: 80F To 180F
Zero Temp Compensation: <2% Of F.S. Per 100F
Span Temp Compensation: <2% Of Reading Per 100F
Excitation: 15 To 25 VDC
Accuracy: 1% Of Full Scale (Combined Linearity, Hysteresis And Repeatability)
Zero Balance: See Ordering Information. An External O-Ring Sealed Zero Adjust Is Provided.
Autoclaving: 250F Max For 1 Hour Max With Power Off. Trim The Balance If Required Following Room Temp Return.
Shunt Calibration Feature: Shorting Pins D & E Simulates The Output Signal Recorded On The Nameplate.
Max Pressure With No Damage: 75000 Psig For 60k, Twice Range For Others

Ordering Information:

Pressure Port: F.S. Pressure Range (Per Fitting): Output (Any):

BE -X	-XXX	-XX
-2: 0.250"OD x 0.109"ID.	-06K, -10K	-01: 0.3 - 10.3 VDC
-3: 0.375"OD x 0.125"ID	-10K, -30K, -60K	-02: 0.5 - 5.5 VDC
-4: 0.250"OD x 0.083"ID	-10K, -20K	
-5: 0.563"OD x 0.188"ID	-06K, -60K	
-6: 0.563"OD x 0.312"ID	-06K, -20K	

Examples: BE-5-60K-01, BE-2-06K-02, BE-3-30K-02

BE-2: Autoclave Eng. Part # CNX4404; 1/4 MP
BE-3: Autoclave Eng. Part # CN 6604; 3/8 HP
BE-4: Autoclave Eng. Part # CN 4404; 1/4 HP
BE-5: Autoclave Eng. Part # CN 9906; 9/16 HP
BE-6: Autoclave Eng. Part # CNX9906; 9/16 MP

Glands And Collars Not Supplied.

CONFIDENTIAL - This document contains proprietary and confidential information of DJ Instruments. No part of the information contained herein may be used, reproduced or disclosed to third parties without the prior written consent of DJ Instruments.

DRAWN BY: Lou	DATE: 1/14/1998	MATERIAL:	
CHECKED BY:	DATE:	FINISH:	
UNLESS OTHERWISE SPECIFIED DIMENSIONS ARE IN INCHES			SCALE
TOLERANCES ON: DECIMALS 2 PLACE: ±0.01 3 PLACE: ±0.005 FRACTIONS: ±1/64 ANGLES: ±0.25			57747
Model BE thru-FLO™ HIGH RANGE PRESSURE TRANSDUCER			REV P
SIZE B			50376